

HOW TO MEASURE BRAKE DRUMS

When selecting a replacement drum, the manufacturer's name and part number is helpful. If this information is not available, a replacement drum can be selected by comparing dimensions. A drawing is shown below which indicates the dimensions required to determine the existence of a replacement drum. If all of the dimensions shown are not available, we must have at least dimensions C, D, E, J, K and O to make a selection.

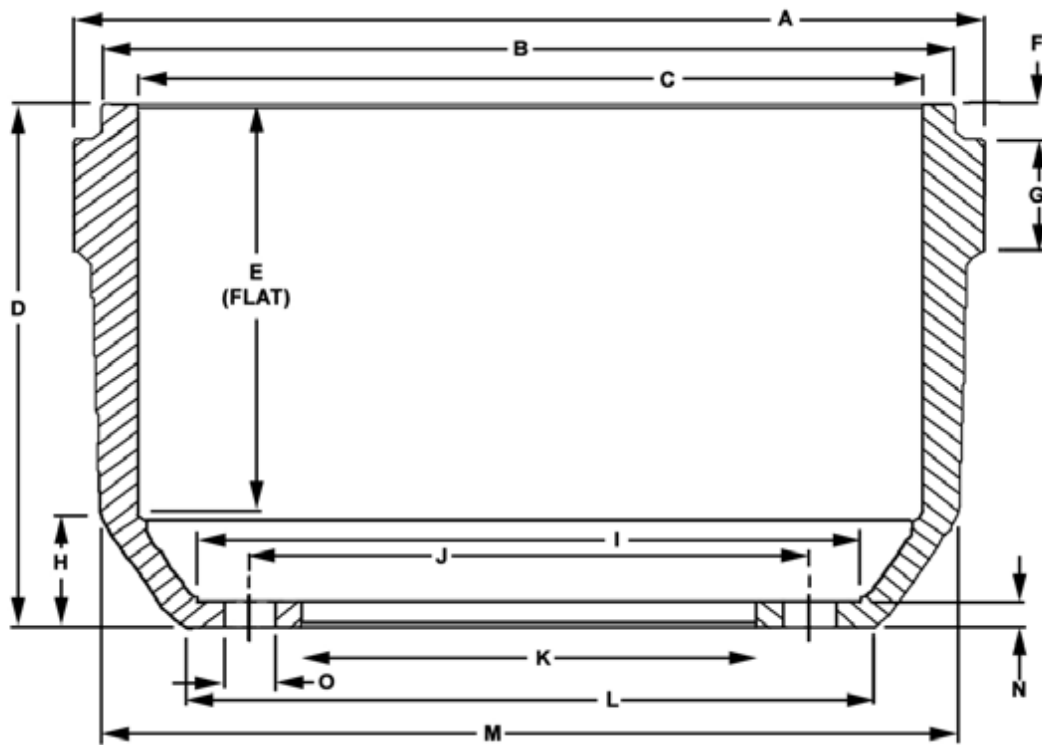

- A. Overall diameter of drum
- B. Dust shield recess diameter, if applicable
- C. Brake surface diameter
- D. Overall depth
- E. Brake surface flat
- F. Depth of dust shield recess
- G. Squeeler band thickness
- H. Distance from outside of backface to start of taper
- I. Inside finished diameter
- J. Bolt circle diameter
- K. Pilot Diameter
- L. Outside finished diameter
- M. Diameter at taper
- N. Backplate thickness
- O. Bolt holes: number and size